

K-PANEL 2.5mm PVC SHEET. (2mm SHEET IS AVAILABLE FOR SUPPLY ONLY).
 1.22m wide x 2.44m OR 3.048m high

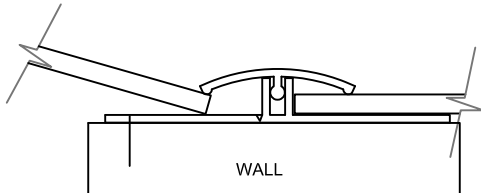

VERTICAL FIXING SINGLE 1:1

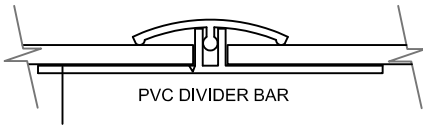
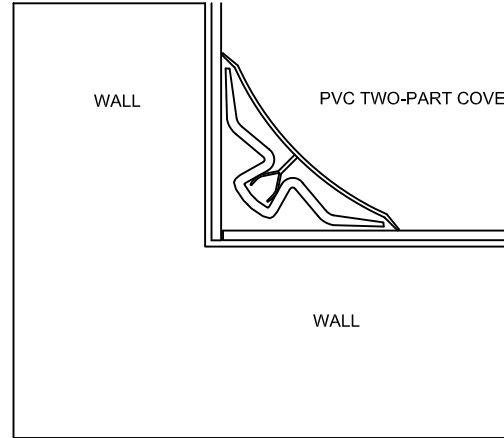

INTERNAL CORNER DETAIL 1:2

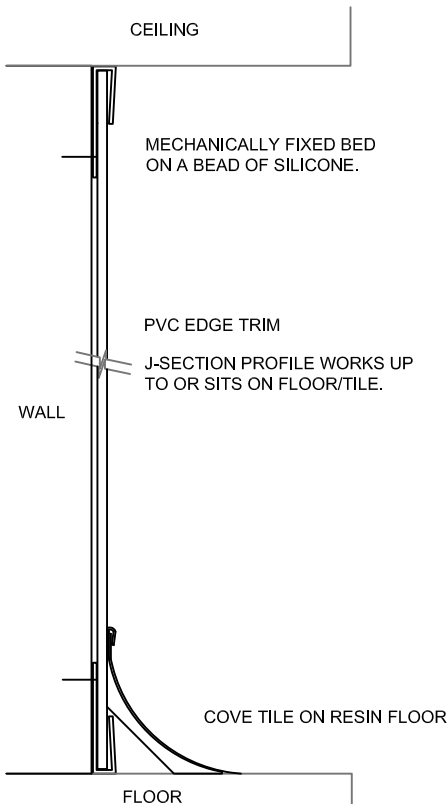

WALL TO FLOOR DETAIL 1:2

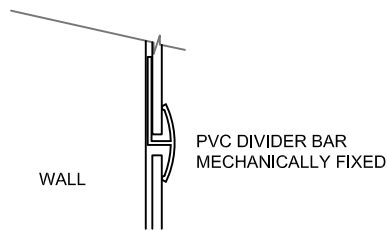

WALL TO FLOOR DETAIL 1:2

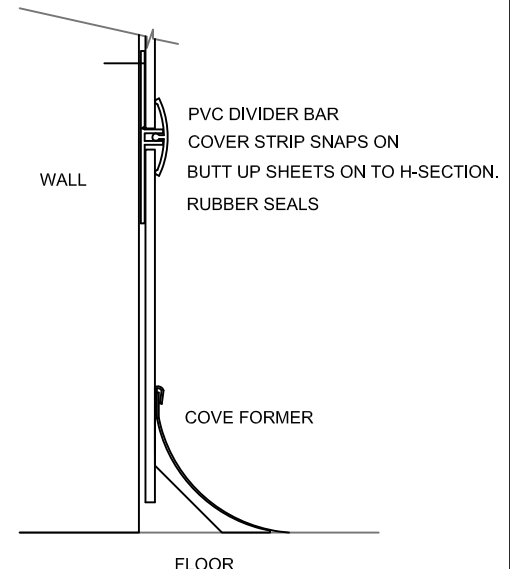

WALL TO FLOOR DETAIL 1:2

NOTES

K-PANEL 2.5mm SHEET NEEDS A PLUM AND FLUSH WALL FINISH TO ACHIEVE A UNIFORM FINISH, ANY LUMPS AND BUMPS IN THE WALL WILL SHOW ANY UNDULATION AND THE SHEET WILL FOLLOW THIS. TO ACHIEVE A SMOOTH FINISH WITH THIS PRODUCT WHEN USED ON A REFURBISHMENT APPLICATION, LINING THE WALL IN PLASTERBOARD OR PLYWOOD WILL GIVE A SMOOTH AND EVEN FINISH TO APPLY THE K-PANEL. AN ALTERNATIVE TO THE 2.5mm K-PANEL IS THE H-PANEL WHICH IS A 10mm THICK SHEET (HYG0011 & HYG0012).

THE SHEETS COME IN 5 STANDARD COLOURS; WHITE, GREY, PASTEL GREEN, IVORY AND PASTEL BLUE, HOWEVER IF YOU ARE LOOKING FOR A BESPOKE SOLUTION VINYL PRINTING IS AVAILABLE AT AN EXTRA COST. CONTACT OUR TECHNICAL TEAM FOR MORE INFORMATION.

CLEANING STRATEGY FOR O&M MANUALS SEE CSO&M DATA SHEET.

NBS Ref: K13/160